



Picture may vary from actual product

Power.Gate



Reliably power
your business

The universal multi-talented addition among parking columns offers comprehensive possibilities for the ticketing sector with modern, diverse ticket technology. Expand your business models and become part of dynamic urban solutions. The SKIDATA Power.Gate supports you with reliability and functionality.

Your business card

High-class materials and salient features blend elegantly into all types of architecture. Bi-directional video communication guarantees optimal customer support. The user interface has been optimized by experts in terms of its look and sound to ensure positive user experiences.

Marketing terminal with ticketing

Additional marketing possibilities help you to finance your own equipment. A backlit, bright, and high-resolution display draws attention to logos, images and promotional videos in the most effective and elegant way.

Increase efficiency through quality

Optimized service planning, scalable capacities and intelligent systems support you and reduce your service costs. The advanced contactless RFID and barcode technology guarantees the highest level of reliability and low follow-up costs.

Future-proof solutions

A customized solution for every application: a stepwise investment in expansion and replacements is made possible thanks to SKIDATA's mix-and-match parking columns. Minimize your power usage and rely on recycleable materials in order to provide a high level of energy efficiency.

all dimensions in mm

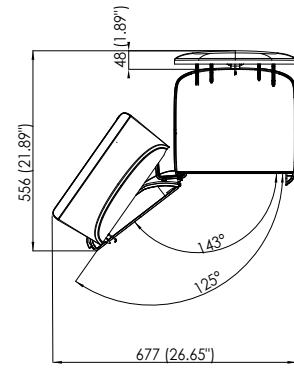
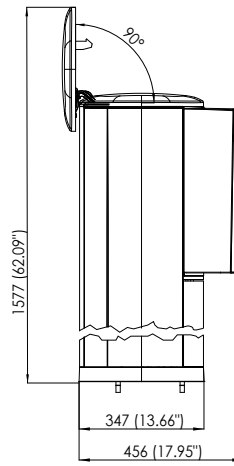
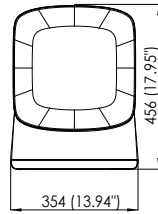
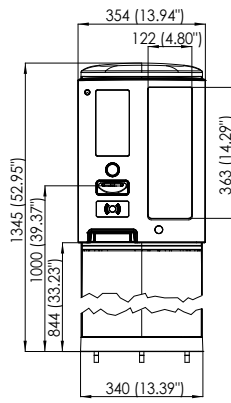

Features

Design/Construction

- High-grade design based on aluminum and synthetics with optional light elements
- Modular, easy to maintain construction
- Flexible extension options ensure maximum investment protection
- Weather-proof, thanks to the use of high-grade durable materials
- Ethernet interface for efficient system integration
- Installation space for add-on modules (e.g., PIN pad, credit card reader, etc.)

Operation

- Intuitive user interaction helps to ensure high processing rates

Green Efficiency

- Low power consumption; without coder no heating is required down to $-20\text{ }^{\circ}\text{C}$ ($-4\text{ }^{\circ}\text{F}$)
- Materials provide a high degree of reusability

Options

Design/Construction

- LED light bar serves as an illuminated eye-catcher
- Housing available in custom colors

Ticket Processing

- Coder Unlimited ensures flexible ticket processing
- Coder Basic enables crosswise barcode ticket processing and punch-hole validation
- RFID module to read and encode RFID tickets (13 MHz)
- Double ticket intake up to 2×7000 tickets, depending on ticket material and coder type) with automatic data carrier management
- Intake which is compatible with RFID tickets
- Ticket collecting box (approx. 3000 tickets)
- Print@Home scanner with special optical array for paper tickets and Smartphones; supports various formats

- Receipt printer accommodates for the entire credit card solution
- Barcode ticket slot for 'classic' ticketing
- Paper ticket printer for cost-efficient tickets (instead of coder)

Communication

- Analog intercom
- Integrated digital intercom (Ethernet or 2-Wire)
- Bidirectional (i. e., duplex) video communication (solution includes camera hardware)

Display

- High-resolution graphics display ensures good readability of commercials and videos (with automatic brightness adjustment); 800×480 pixels
- Touch screen for outdoor use to provide additional parking column functionality (can be operated while wearing protective gloves)
- Display modes support various applications and design options
- Illuminated control elements
- Visual and acoustic feedback provides additional user support

Accessories

- Locking system with mechanical or electronic locks, supports configurable access permissions
- Various contact and interface extensions to suit a wide range of requirements
- Heating and cooling for extreme ambient temperatures
- Info field at the front
- AFILS Acoustic support for clear intelligibility
- Advertising panel
- Lane signal
- Base for truck lanes 40, 60, 80, 100, 120 cm
- Touchless ticketbutton

Technical Details

Dimensions	354 mm × 1345 mm × 456 mm / 13.94" × 52.95" × 17.95" (w × h × d) without any additional options
Weight	approx. 30 kg
Operating voltage	100-240 V ±10 % / 50-60 Hz
Power consumption	min. 18 W max. 270 W including heating $-20\text{ }^{\circ}\text{C}$ ($-4\text{ }^{\circ}\text{F}$) in total 670 W including heating $-40\text{ }^{\circ}\text{C}$ ($-40\text{ }^{\circ}\text{F}$) in total 920 W
Coding units	Coder Unlimited or Coder Basic
Operating temperature with Coder	$0\text{ }^{\circ}\text{C}$ ($32\text{ }^{\circ}\text{F}$) to $+50\text{ }^{\circ}\text{C}$ ($122\text{ }^{\circ}\text{F}$) in shade; $+40\text{ }^{\circ}\text{C}$ ($104\text{ }^{\circ}\text{F}$) when exposed to sunlight
Operating temperature without Coder	$-20\text{ }^{\circ}\text{C}$ ($-4\text{ }^{\circ}\text{F}$) to $+50\text{ }^{\circ}\text{C}$ ($122\text{ }^{\circ}\text{F}$) in shade; $+40\text{ }^{\circ}\text{C}$ ($104\text{ }^{\circ}\text{F}$) when exposed to sunlight
Operating temperature with additional cooling	up to $+50\text{ }^{\circ}\text{C}$ ($122\text{ }^{\circ}\text{F}$) when exposed to sunlight
Operating temperature with an additional heater	down to $-20\text{ }^{\circ}\text{C}$ ($-4\text{ }^{\circ}\text{F}$)
Operating temperature with an additional large heater	down to $-40\text{ }^{\circ}\text{C}$ ($-40\text{ }^{\circ}\text{F}$)
Max. humidity	90 % (non-condensing)
Standard colors	Base: Brushed, anodized aluminum; Cover: Dusty gray RAL 7037, synthetic; Panel: Dark gray RAL 7021, synthetic
Guidelines / Certifications	CE (incl. WEEE), FCC, IC, $c_{\text{NRTL}}_{\text{US}}$
Degree of protection based on IEC 60529	IP43
System requirements	Parking.Logic V07 or higher